



c2:concepts  
**Case Study: Barclays, Manchester**

Completed 2014

c2:concepts  
Considered, creative.

# Barclays Bank Manchester Regional Office



c2:concepts  
Considered, creative.

[www.c2concepts.co.uk](http://www.c2concepts.co.uk)



**Location:** 4 Piccadilly Place, Manchester

**Project Size:** 82,000 sq ft

**Procurement:** Design & Build

**Status:** Built (2014)

**Team members:** Designer: c2; PM: EC Harris, QS: Turner & Townsend, M&E: Cundalls, Contractor: Overbury

In an asset management review Barclays decided to consolidate its Manchester retail and business banking division from two sites in the city into one at 4 Piccadilly Place. Further to c2's prototype "Hearts & Minds" contact centre for Barclays being introduced at Sunderland and Liverpool, c2: were commissioned to design the new Manchester office combining a new approach to Barclays office design with the Hearts & Minds approach. Accommodating 1000 staff, 4 Piccadilly Place provides a modern contact centre with additional office space for full support services.

# Barclays Bank Manchester Regional Office



c2:concepts  
Considered, creative.

[www.c2concepts.co.uk](http://www.c2concepts.co.uk)

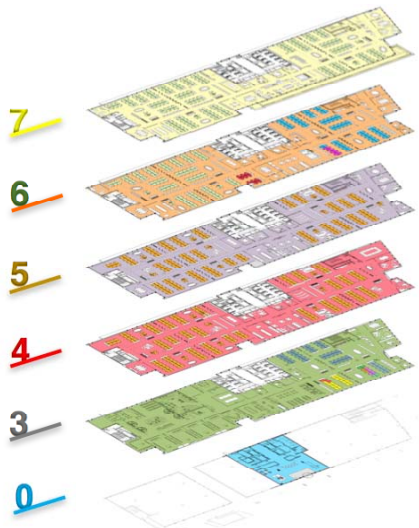
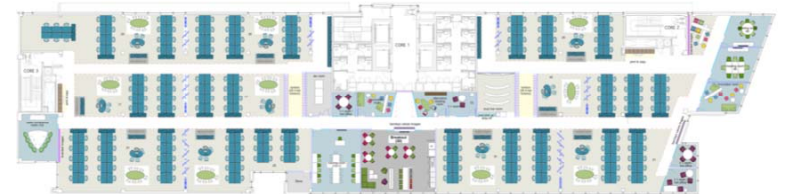

**Location:** 4 Piccadilly Place, Manchester

**Project Size:** 82,000 sq ft

**Procurement:** Design & Build

**Status:** Built (2014)

**Team members:** Designer: c2.; PM: EC Harris, QS: Turner & Townsend, M&E: Cundalls, Contractor: Overbury

In an asset management review Barclays decided to consolidate its Manchester retail and business banking division from two sites in the city into one at 4 Piccadilly Place. Further to c2's prototype "Hearts & Minds" contact centre for Barclays being introduced at Sunderland and Liverpool, c2: were commissioned to design the new Manchester office combining a new approach to Barclays office design with the Hearts & Minds approach. Accommodating 1000 staff, 4 Piccadilly Place provides a modern contact centre with additional office space for full support services.

This document has been prepared by c2:concepts Ltd for sole use by our client or professional team within this specific project, in accordance with the legally binding professional consultancy appointment and terms of reference for this project. Copyright for the contents herein, in whole or part is owned by c2:concepts Ltd unless otherwise agreed and may not be copied, extracted or distributed to a third party without permission.

Drop us a line or call in and see us.  
**We'd love to talk about potential projects.**

**Glasgow office:**  
c2:concepts  
Queen's House  
29 St. Vincent Place  
Glasgow  
G1 2DT

0141 221 9229

**London office:**  
c2:concepts  
33 Cavendish Square  
London  
W1G 0PW

0203 011 1984

**c2:concepts**  
Considered, creative.